

8. Sorter stapler installation environment

< Phenomenon >

When direct sunlight strikes the bin jam sensor (a photo transistor), it causes a sensor malfunction, and the machine does not staple even if staple mode is selected.

< Countermeasure >

- 1) Avoid installing the machine under direct sunlight
- 2) Install a piece of mylar around the bin-jam sensor (photo-transistor) to protect from direct sunlight.

SUBJECT: F400/F410 Troubleshooting

DATE: Nov.30, '93

PAGE: 8 of 10

10. Sorter Stapler Entrance jam

< Phenomenon >

If the mylar is set incorrectly, paper jams frequently occur around the sorter stapler entrance.

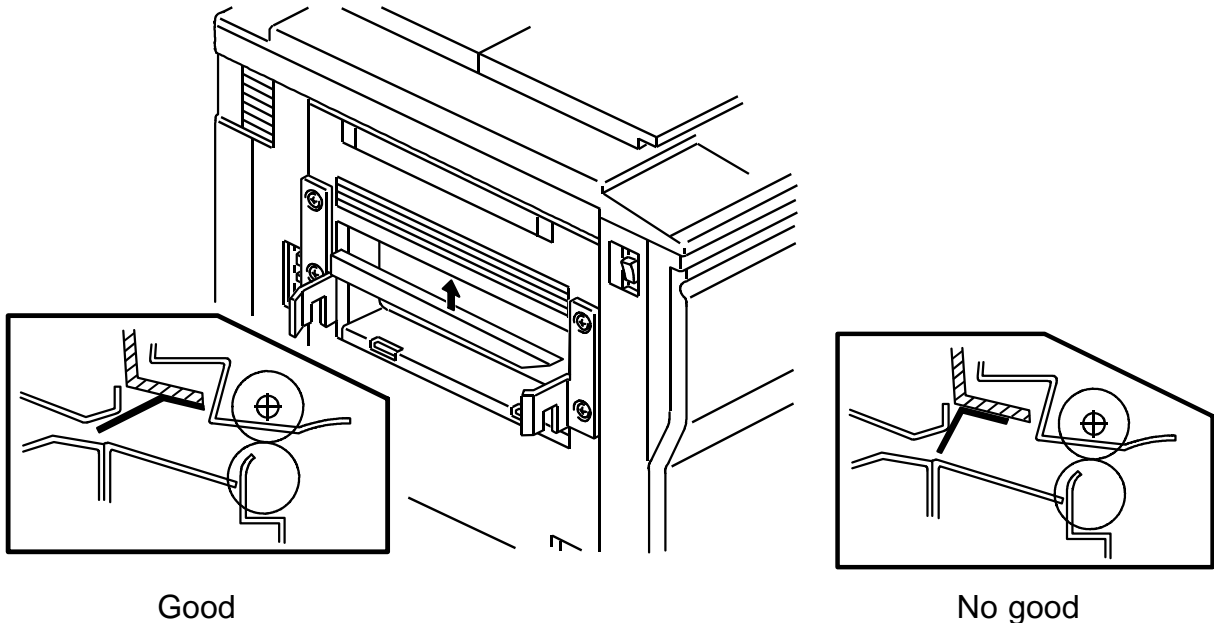

Good

No good

< Countermeasure >

Set the mylar in the correct position without buckling, curling or waving.

SUBJECT: SORTER STAPLER (A377) ENTRANCE GUIDE

DATE: Jan. 31, '93

PAGE: 1 of 6

PREPARED BY: S. MANO

FROM: Copier Technical Support Section

CHECKED BY:

CLASSIFICATION:

Action Required

Troubleshooting

Retrofit Information

Revision of service manual

Information only

Other

MODEL:

F400/F410

SORTER STAPLER

(A377)

It has been reported that several sorter stapler (A377) entrance guides became deformed. This occurs when the sorter stapler (A377) is taken out of the carton or during transportation.

Because the entrance guide plate sticks out from the machine, it is held and bend by the transportor or it is hit during transportation.

To prevent the deformation of the sorter stapler entrance guide plate, the entrance guide plate [A] is separated from the sorter stapler and attached on the front door.

This is implemented from the first February 1994 production machines.

Whenever transporting the sorter stapler after taking out of the carton box, separate the guide plate from the sorter stapler. Reset it just before you dock the sorter stapler to the copier.

The installation procedure (accessory) is modified too. Please refer to the following pages. Step #11 has been added. The other steps are the same as before.

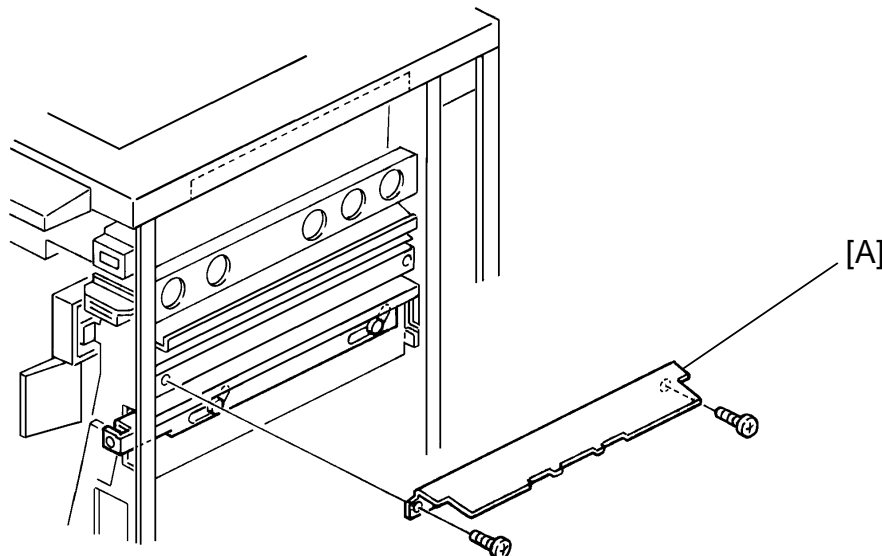

INSTALLATION PROCEDURE

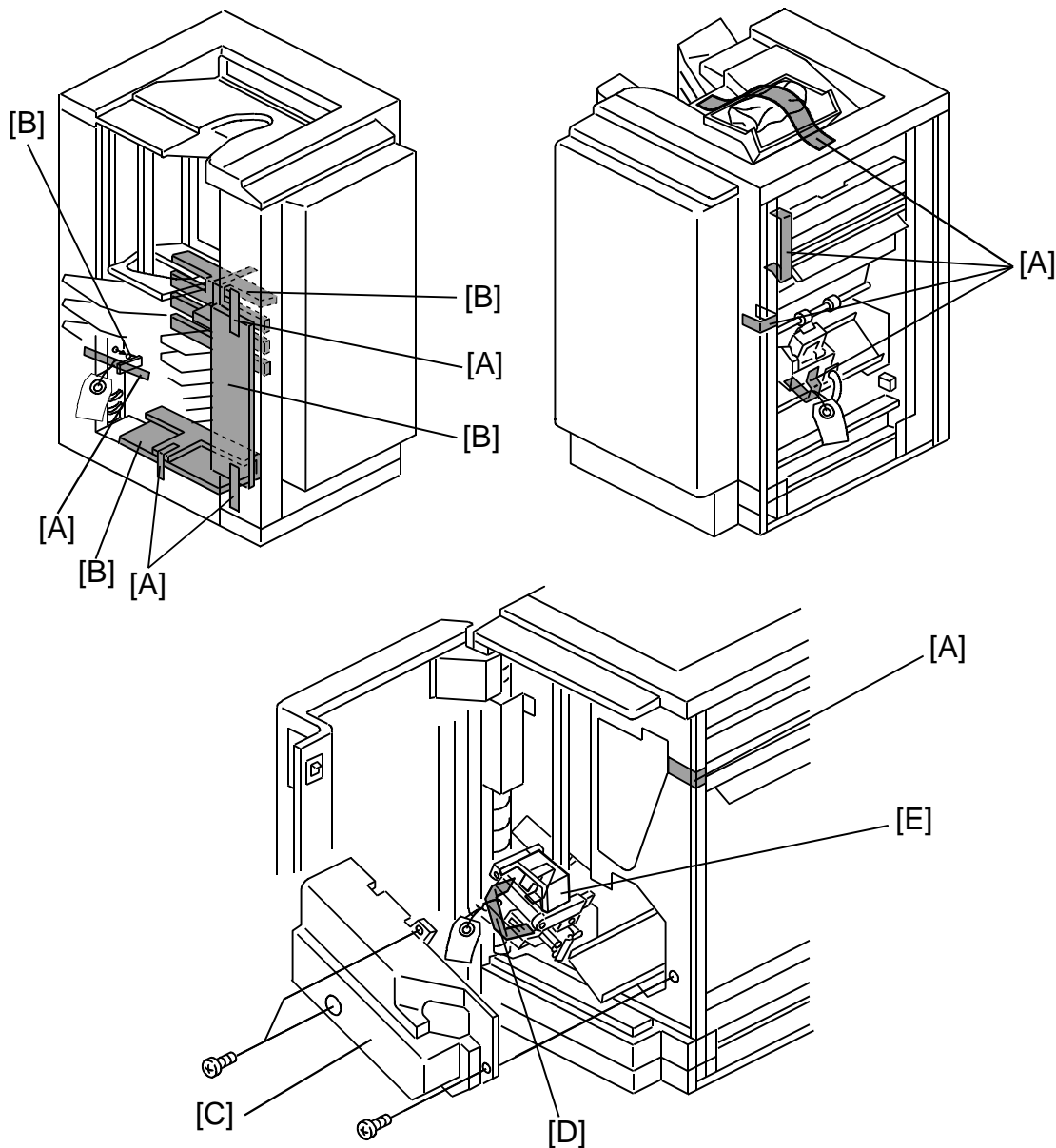

CAUTION: Unplug the copier power cord before starting the following procedure.

1. Remove the strips of tape [A] and the cushions [B].
2. Open the front door and remove the inner cover [C] (3 screws).
3. Remove a strip of tape [D] securing the gripper unit and remove a cushion [E]. Then re-install the inner cover [C].

SUBJECT: SORTER STAPLER (A377) ENTRANCE GUIDE

DATE: Jan. 31, '93

PAGE: 3 of 6

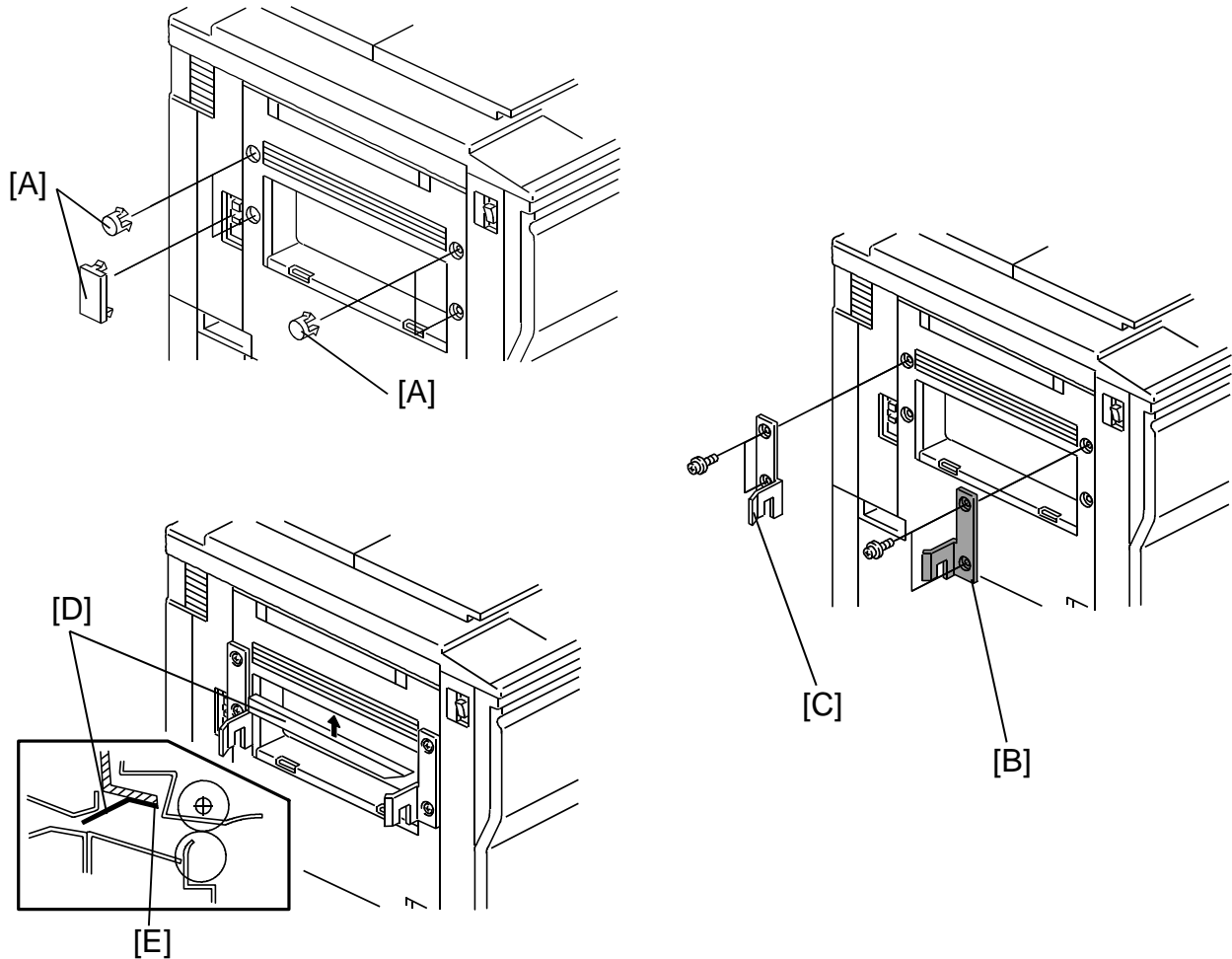

4. Remove five plastic caps [A] on the copier's left cover.
5. Install the front connecting bracket [B] (2 screws - M4 x 12) and the rear connecting bracket [C] (2 screws - M4 x 12) on the copier.
6. Stick the entrance guide mylar [D] on the copier exit area as shown.
NOTE: Align the edge [E] of the cover and mylar.

SUBJECT: SORTER STAPLER (A377) ENTRANCE GUIDE

DATE: Jan. 31, '93
PAGE: 4 of 6

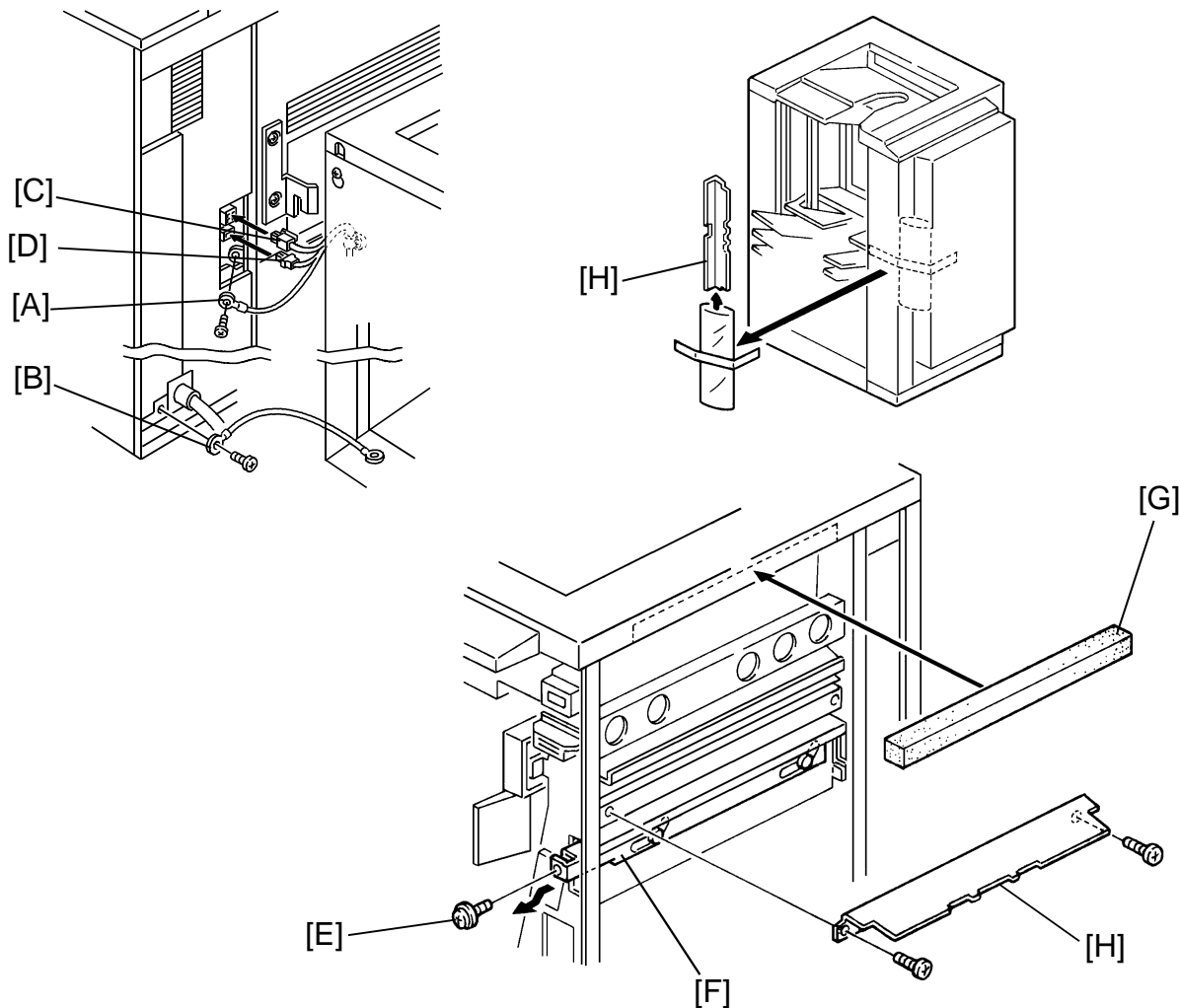

7. Secure the protective earth wire [A]* (1 screw with spring washer) and the wire [B] (1 screw with spring washer).
NOTE*: For all models other than those intended for North America, the green wire is intended as a functional ground and should be connected as shown.
8. Connect the 4P connector [C] and the fiber optic connector [D].
9. Open the front door of the sorter stapler and remove the screw [E] fixing the locking lever [F], then lower the locking lever.
10. Stick the cushion [G] on the proof tray.
11. Install the entrance guide plate [H] (2 screws -M4 x 6) which is in the bag on the front door.
12. Align and press the sorter stapler against the copier and fix them by raising the locking lever [F].

SUBJECT: SORTER STAPLER (A377) ENTRANCE GUIDE

DATE: Jan. 31, '93

PAGE: 5 of 6

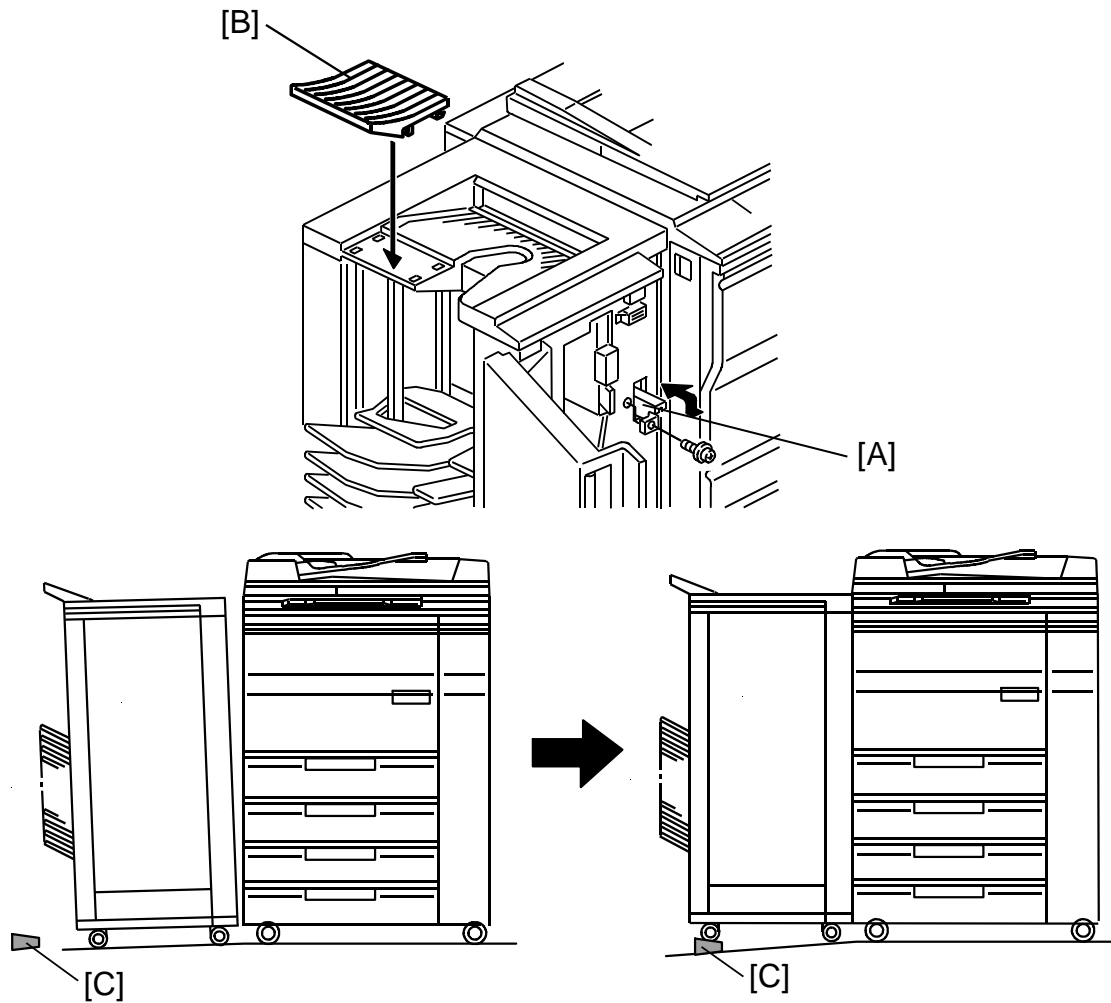

13. Secure the locking lever [A] (1 screw).

14. Install the proof tray [B].

15. If the gap between the top of the sorter stapler and the copier is too great, adjust by placing caster stoppers [C].

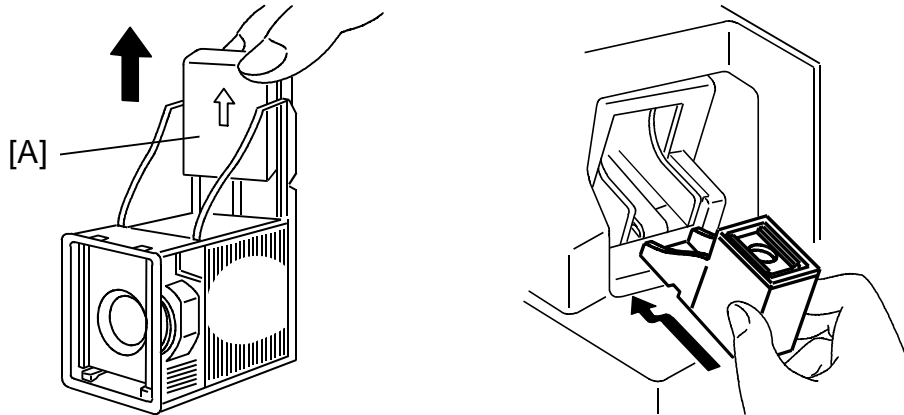

16. Remove the green plastic clip [A] from the staple cartridge, and install the cartridge in the stapler.

NOTE: When installing the staple cartridge, make sure that all the staple sheets [B] are in the initial position.

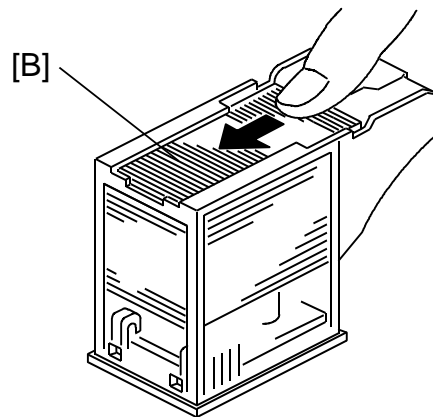

17. Plug in the copier.

18. Turn on the main switch of the copier and test the operation of the sorter stapler.

NOTE: The copier automatically recognizes that the sorter stapler has been installed.

The stapler will not staple for the first 10 or so copies until the first staple moves to the proper position from the cartridge.

Page 1 of A377 Sorter Stapler Table (Minimum paper size, Sort mode)

- Incorrect:
A5 5 1/2" x 8 1/2" lengthwise
- Correct:
lengthwise: A5 5 1/2" x 8 1/2"
Sideways: A5 8 1/2" x 11"

A5 sideways is long enough for transport rollers's distance. It is small difference but 5 1/2 inch is not long enough for transport roller's distance. Therefore the minimum side of inch size paper (side ways) is 8 1/2" x 11".

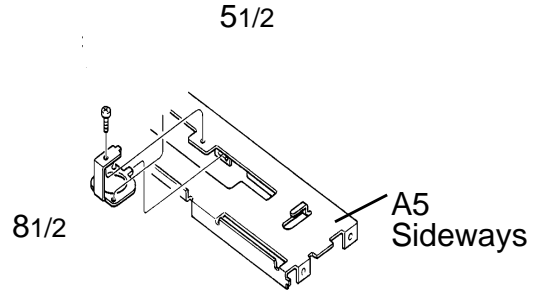

- Incorrect

Power Consumption Average less than 80W
Maximum:
 in sort/stack mode: less than 100W
 in staple mode: less than 300W

Weight: Approximately 52 kg

- Correct

Power Consumption Average less than 55W
Maximum:
 in sort/stack mode: less than 55W
 in staple mode: less than 42W

Weight: Approximately 47 kg